



**MIIG<sup>®</sup> 115**  
**Mixing Instructions**  
**128800-5**

The following languages are included in this packet:

English (en)	Deutsch (de)	Nederlands (nl)	Français (fr)
Español (es)	Italiano (it)	Português (pt)	中文-Chinese (sch)
Türkçe (tk)			

For additional languages, visit our website [www.wmt.com](http://www.wmt.com)

Then click on the **Prescribing Information** option.

For additional information and translations please contact the manufacturer or local distributor.



Wright Medical Technology, Inc.  
P.O. Box 100  
Arlington, TN 38002  
U.S.A.

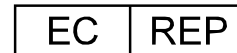

Wright Medical EMEA  
Krijgsman 11  
1186 DM Amstelveen  
The Netherlands

**\* The CE-Marking of Conformity is applied per catalog number and appears on the outer label, if applicable.**

**Rx ONLY**  
November 2009  
Printed in U.S.A.

# MIIG™ 115

## Minimally Invasive injectable Graft

(128800-5)

### Indications

The MIIG™ paste is intended to be injected into open bone voids/gaps that are not intrinsic to the stability of bony structure of the skeletal system (i.e., the extremities, spine, and pelvis) and to cure *in-situ*. These open bone voids may be surgically created osseous defects or osseous defects created from traumatic injury to the bone. The MIIG™ paste provides a bone void filler that resorbs and is replaced with bone during the healing process.

The MIIG™ paste cured *in situ* provides an open void/gap filler that can augment provisional hardware (e.g., K-Wires) to help support bone fragments during the surgical procedure. The cured paste acts only as a temporary support media and is not intended to provide structural support during the healing process.

## MIXING INSTRUCTIONS

**1•1•5**  
 1 minute mixing & prep time  
 1 minute injection time  
 5 minutes setting time

**IMPORTANT:** Do not begin until the grafting site is prepped and ready for injection. The appropriate needle should be pre-placed under fluoro prior to mixing.

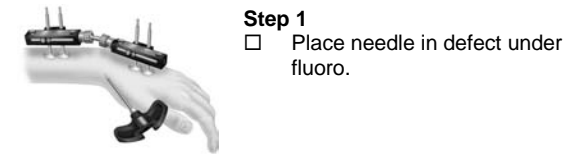

- Step 1**
- Place needle in defect under fluoro.



- Step 2**
- Remove plunger from syringe, set aside

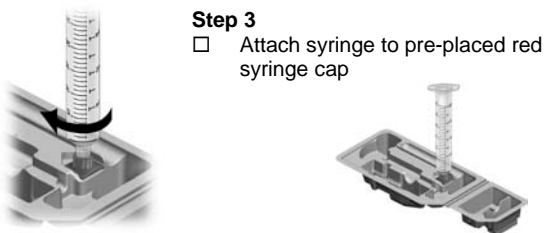

- Step 3**
- Attach syringe to pre-placed red syringe cap



- Step 4**
- If using the miniMIIG™ syringe, insert the supplied funnel into syringe
  - Pour all of the saline provided into the syringe.



- Step 5**
- IMPORTANT: STEPS 5 – 8 SHOULD BE COMPLETED IN 1 MINUTE OR LESS.**

- Carefully pour all of the powder on top of the liquid.



- Step 6 (complete in approximately 40 seconds)**
- If using the miniMIIG™ kit, remove funnel
  - Use the provided spatula to mix the powder and solution together. “Twirling” the spatula between fingers may aid in the mixing process.

**IMPORTANT: This material takes approximately 30 seconds to “wet out”. It is very important that you do not add any more liquid to the syringe.**



- Step 7**
- Remove syringe from holder
  - Insert plunger into the syringe barrel.
  - Gently tap the syringe in an inverted position to move the excess air to the top of syringe (right).

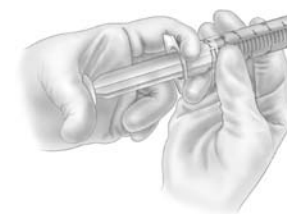

- Step 8**
- Remove the red syringe cap.
  - Before connecting to delivery needle, remove excess air by advancing plunger to indicated volume on the syringe:
    - **miniMIIG™ = 5cc**
    - **MIIG™115 = 15cc**



- Step 9**
- Attach syringe to the pre-placed needle.
  - Immediately inject paste into the defect site.
  - Avoid overfilling the bone void or pressurizing the treatment site.

*Residual material may be left in syringe. The amount of remaining material is relative to user's adherence to the mixing and ejecting times outlined in these instructions.*

**NOTE:**

The paste should be allowed to set prior to definitive hardware placement (approximately 5-7 minutes).